

■ FNP Fixed Socket, Nut Fixing, Front Fasten

- Connector series: FNP
 - Contact: Hermaphroditic
 - Locking type: Self-locking
 - Orientation type: Straight
 - Part No.: FNP.XE.XXX.CLL
 - Mated with: PSA/POA/PPP series
- Note: "X" refers to part number definition on page 101

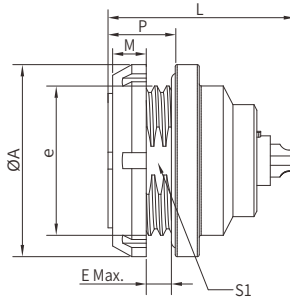

■ General Information

Ambient temperature:	-55°C ~ + 200°C	Seal/O-ring:	Silicone
Endurance:	>5000 cycles	Insulation resistance:	≥100MΩ
Insulator:	PEEK	IP rating:	IP68
Connector contacts:	Brass with gold plated	Shielding efficiency:	at 10MHz>95dB/at 1GHz>80dB
Coupling nut/screw:	Brass with Cr plated	Salt spray corrosion test:	>144h
Housing:	Brass with Cr plated		

Size	Dimensions(mm)						
	A	e	E	L Max	M	P	S1
0E	18	M14*1.0	3.5	21.7	3.5	7.0	12.5
1E	20	M16*1.0	6.5	27.0	3.5	10.0	14.5
2E	25	M20*1.0	6.5	30.7	3.5	10.0	18.5

Note: Panel cut-out (page 164)

■ ASA Free Socket, Nut For Bend Relief

- Connector series: ASA
 - Contact: Hermaphroditic
 - Locking type: Self-locking
 - Orientation type: Straight
 - Part No.: ASA.XE.XXX.CLLCXXZ
 - Mated with: PSA/POA/PPP series
- Note: "X" refers to part number definition on page 101

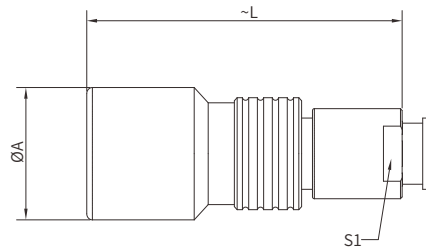

■ General Information

Ambient temperature:	-55°C ~ + 200°C	Seal/O-ring:	Silicone
Endurance:	>5000 cycles	Insulation resistance:	≥100MΩ
Insulator:	PEEK	IP rating:	IP68
Connector contacts:	Brass with gold plated	Shielding efficiency:	at 10MHz>95dB/at 1GHz>80dB
Housing:	Brass with Cr plated	Salt spray corrosion test:	>144h

Size	Dimensions(mm)		
	A	L	S1
0E	13	34	7
1E	15	45	9
2E	19	54	12